

Tempsens make hollow pin standard connector for thermocouple type J, K, N, T, E, R/S. Hollow pin design offers a good quality product at competitive price.

Constructions

- ✓ PBT (20% glass filled) material.
- ✓ Polarized pins.
- ✓ Sandwich construction enables easy wire connection.
- ✓ Philips head screw (SS material).
- ✓ Crimp style bushings(SS material).
- ✓ Connector with clamp also available.



Temperature Rating

- ✓ 175°C Max.

Color Code

- ✓ Available according to ANSI and IEC.

Wire Size

- ✓ Wire size Up to 1.6mm
- ✓ Maximum cable diameter 8 mm.

Construction

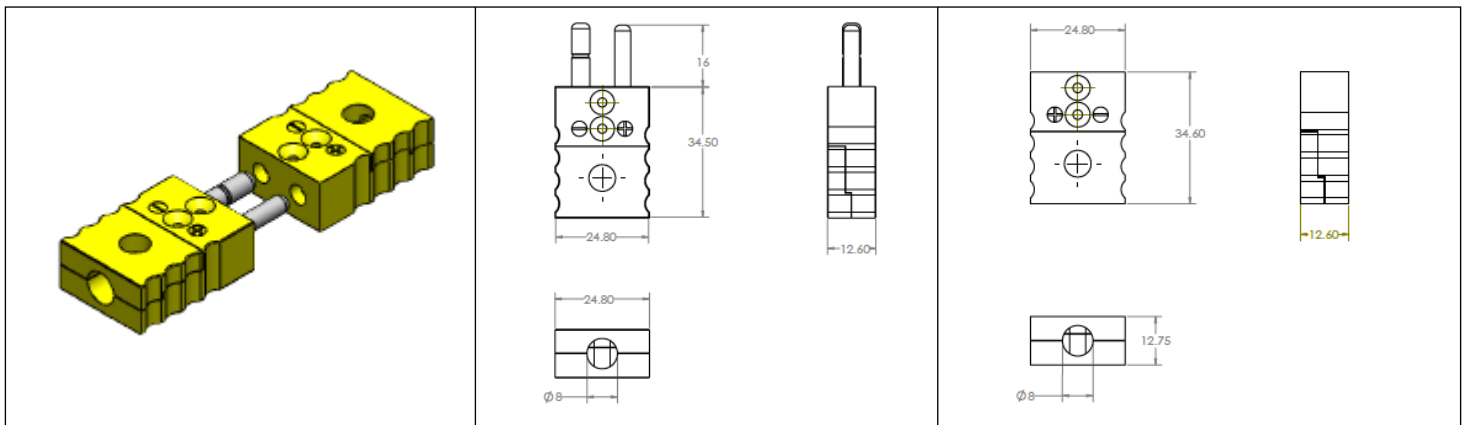

Ordering Code

Connector

CON

Type

ST

Thermocouple Type

(X)

J	E
K	R/S
N	B
T	

Connector Contact

(X)

M
F

Standard

(X)

I
A

MI - Miniature
ST - Standard
I - IEC
A - ANSI

Order Example : CON - ST - K - M - I, Connector-Standard Thermocouple Type-K-Male Connector as per-IEC
CON - ST - K - F - A, Connector-Standard, Thermocouple Type-K-Female Connector as per-ANSI

Thermocouple Type	(+) Contact	(-) Contact	Color Code	
			ANSI	IEC
J	Fe	Cu Ni	Black	Black
K	Ni Cr	Ni Al	Yellow	Green
N	Ni Cr Si	Ni Si	Pink	Pink
T	Cu	Cu Ni	Blue	Brown
E	Ni Cr	Cu Ni	Violet	Violet
R/S	Cu	RNX/ SNX	Green	Orange
B	Cu	Cu	Grey	Grey